

Car Wash Systems Inc Simpson Ferry

RLS Construction Group was chosen to construct a new car wash facility, on Simpson Ferry Road, in Lower Allen Township, Mechanicsburg, PA. The project work will include land development plans, grading, cut/fill, stormwater, curbs, sidewalks, paving and line striping. Additionally, the facility will consist of two (2) pre-manufactured automatic bays, erected on the site, and associated equipment rooms with 8" block walls, featuring core insulation, a metal joist roof and an insulated membrane roof over metal roof decking.

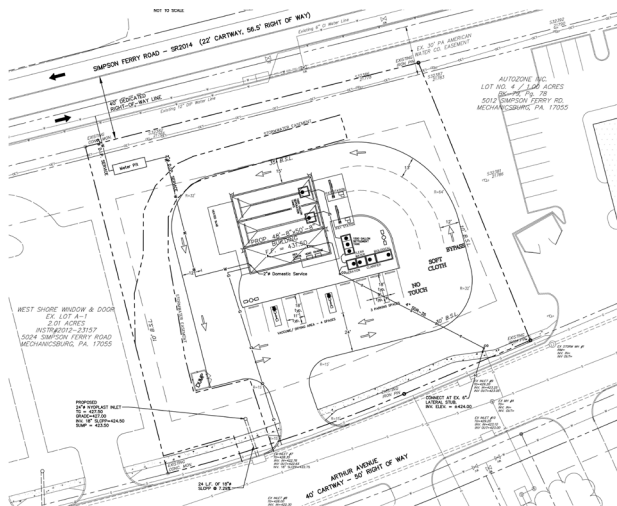

CAR WASH
S Y S T E M S

Location:
Mechanicsburg, PA

Client:
Car Wash Systems Inc

Cost:
\$300,000

Completion Date:
on-going

RLS

CONSTRUCTION GROUP



- General Construction
- Design/Build
- Construction Management
- Building Maintenance

**Relationships
Loyalty &
Solutions**

A Service-Disabled Veteran-
Owned Small Business



www.RLSCG.com
717.502.6680