

# VA Maryland Health Care System Loch Raven Outpatient Clinic

**RLS Construction Group** was selected by the Department of Veterans Affairs to provide renovations for the north entrance to the Loch Raven Outpatient Clinic, located in Baltimore. The scope of the project includes repairs and modifications to the entrance to achieve ADA compliance, as well as to address issues with stormwater run-off. The work involves specific safety protections for patients and staff using the facility, particularly during normal business hours, as well as precautions for avoiding disruptions to traffic flow, utility service, and building systems. The finished project will feature a covered handicapped entrance from the adjacent parking lot.

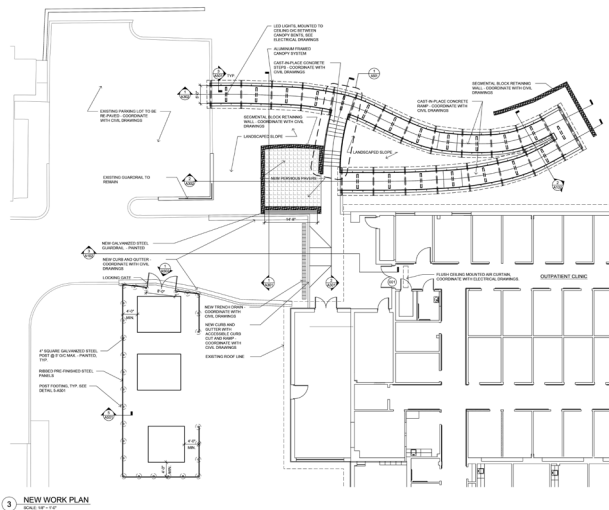

Location:  
**Baltimore, MD**

Client:  
**Department of  
Veterans Affairs**

Cost:  
**\$615,000**

Completion Date:  
**on-going**

**RLS**

CONSTRUCTION GROUP



- General Construction
- Design/Build
- Construction Management
- Building Maintenance

**Relationships  
Loyalty &  
Solutions**

A Service-Disabled Veteran-  
Owned Small Business



www.RLSCG.com  
717.502.6680