

DATE: January 17, 2023

DEPARTMENT OF GENERAL SERVICES
BUREAU OF CAPITAL PROJECT DESIGN MANAGEMENT
1800 HERR STREETS
HARRISBURG, PENNSYLVANIA

ADDENDUM NO. 4

on

PROJECT NO. DGS C-0114-0006 PHASE 001
PROJECT TITLE - Hickory Run State Park - Latrine Improvements
PROFESSIONAL:

SMP Architects
1600 Walnut Street
Philadelphia, PA, 19103

If you submitted a bid prior to this Addendum being issued, your bid has been discarded and you must re-submit your bid(s) prior to the bid opening date and time.

Response to Bidder Questions

1/13/23

All Contracts

1. None.

.1 Contract

1. On the interior of the buildings above the CMU attached to both the wood stud walls and the underside of the roof trusses call for a Vinyl siding. Its shown both in a vertical application on the walls and a horiz. application on the ceiling. Please provide a specification for this product as I can not find anything in the construction documents and don't know what we should be bidding.

Response: Refer to Specification Section 074610, already included in the documents.

2. After looking through the specifications for this project, we have some questions regarding the fiber cement siding. In the James Hardie Artisan Collection the only Lap Siding that fits the dimensions requested is a Ship Lap siding. In their standard collection, they do also make a regular Plank Lap Siding in the dimensions required. Can you please confirm if they are looking for the Artisan shiplap siding or a standard plank lap siding?

Response: It appears as if the specified basis-of-design siding product is not currently available (despite images of it appearing on the Hardie website). Provision of Hardie Plank Lap Siding in Smooth, in the specified exposure dimension and maintaining the mitered detail shown on the Drawings, would be acceptable. Note that the specifications also list another potential siding manufacturer.

3. The Max allowed width of the exterior hopper style windows is 60" as per the manufacturer.. On drawing A-24 the windows widths exceed this. Please advise if we should add an additional window in the same sized opening to allow the individual windows to be under 60" each.

Response: Refer to attached sketch ASK-1 for two revised window types.

.2 Contract

None.

.3 Contract

None.

.4 Contract

None.

LOOP C

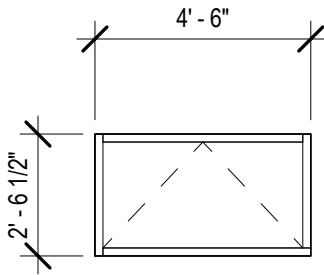

01

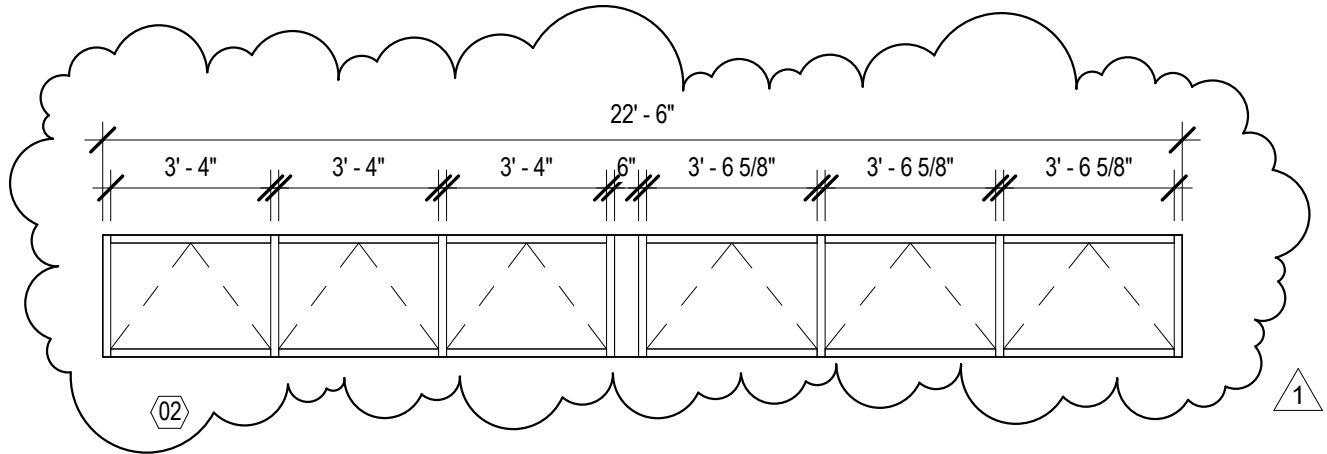

02

1

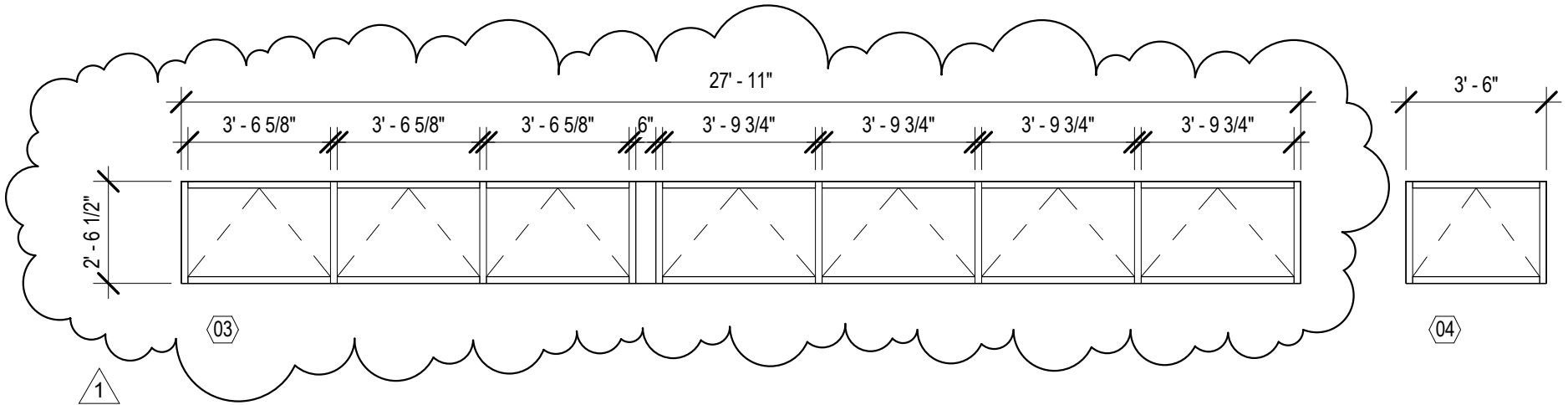

03

04

1

SMPARCHITECTS

1600 Walnut Street, 2nd Floor
Philadelphia, Pennsylvania 19103
215 985 4410

JOB NAME:
**HICKORY RUN STATE PARK
LATRINE IMPROVEMENTS**

JOB NUMBER:
723

DATE:
01/13/23

SCALE:
1/4" = 1'-0"

CONSULTANT:
-

SHEET REFERENCED:
A24

TITLE:
REVISED WINDOW TYPES 2 & 3

DRAWING NO.:
ASK-1