

ADD ALTERNATE NOTES:
 ADD ALTERNATE NO. 6: FIT OUT PATIENT'S LAUNDRY ROOM.
 SCOPE INDICATED REPRESENTS ADD ALTERNATE NO. 6
 BASE BID SCOPE SHALL SHELL RESIDENT LAUNDRY ROOM
 INCLUDING ELIMINATING LAUNDRY WASHING MACHINE AND
 DRYER EQUIPMENT.

LEBANON CLC FOODSERVICE EQUIPMENT SCHEDULE			
Item No	Qty	Equipment Category	Furnished & Installed by
01	1	Drop-in Sink	CFCI
02	1	Coffee Maker (Vendor Supplied)	OFOI
03	2	Microwave Ovens	OFOI
04	1	4 Slot Toaster	OFOI
05	1Lot	Counter (Specified Millwork by Array)	CFCI
06	1	Counter Top Ice/Water Dispenser	OFOI
07	2	Refrigerator w/Freezer Base	OFOI
08	1	Undercounter Dishwasher	OFCI
09	---	Spare Number	
10	1	Drop-in 3 Compartment Sink	CFCI
11	1Lot	Counter (Specified Millwork by Array)	CFCI
12	1Lot	Island Counter (Specified Millwork by Array)	CFCI
13	1	Drop-in Sink	CFCI
14	1	Double Deck Wall Oven	OFCI
15	1	Range Top	OFCI
16	1	Exhaust Hood w/Fire Suppression System	CFCI
17	1Lot	Counter (Specified Millwork by Array)	CFCI
18	---	Spare Number	
19	1	2 Door Refrigerator/Freezer	OFCI
20	1	Hand Sink	CFCI
21	3	Worktables 30x84	OFOI
22	1	Manual Can Opener	OFOI
23	1	Mobile Worktable w/Adjustable Height	OFOI
24	1Lot	Storage Shelving Units	CFCI
25	1	Washing Machine	OFOI
26	1	Dryer	OFOI

Owner Furnished Contractor Installed	OFCI
Contractor Furnished Contractor Installed	CFCI
Owner Furnished Owner Installed	OFOI

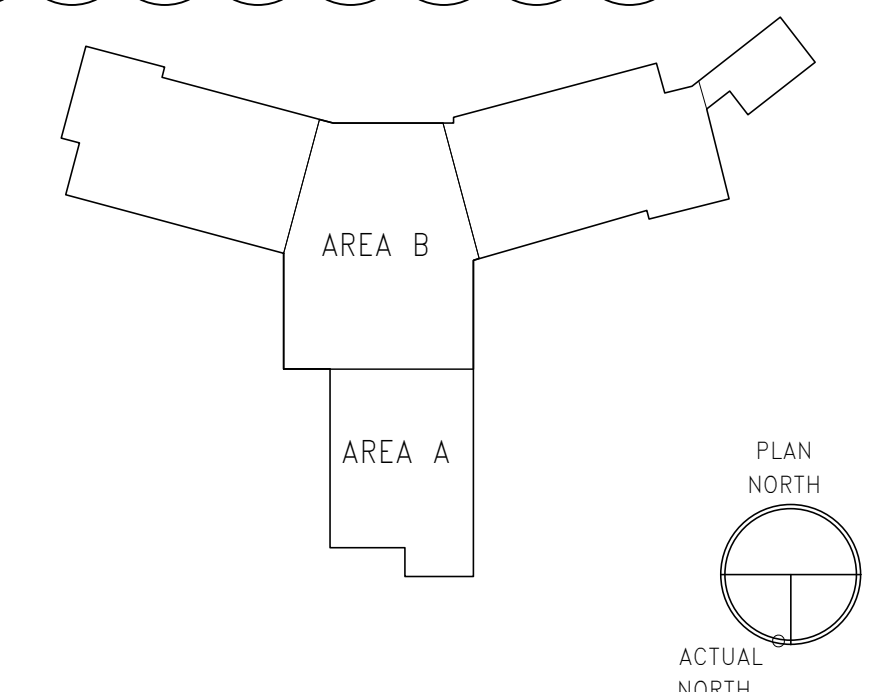

1 FIRST FLOOR FOODSERVICE EQUIPMENT DRAWING - AREAS A & B
 1/4" = 1'-0"

PRINTS OF THIS DRAWING SHALL NOT BE USED FOR ANY PURPOSE WHATSOEVER WITHOUT THE SEAL AND SIGNATURE OF THE PROFESSIONAL ENGINEER.	CONSULTANT ARRAY-ARCHITECTS.COM 1 West Elm Street, Ste 400 Conshohocken, PA 19428 o: 610-270-0599 f: 601-270-0995	ENGINEER OF RECORD Gordon PROGRAMMING AND PLANNING CIVIL ENGINEERING LANDSCAPE ARCHITECTURE SURVEY AND MAPPING SECURITY CONSULTING 148 S Queen St, Suite 201 Martinsburg, WV 25401 Phone: 304-725-8456 www.gordon.us.com	ENGINEER OF RECORD Miller-Remick LLC M.E.P. & Structural Engineering A Service Disabled Veteran Owned Small Business 1010 KINGS HIGHWAY SOUTH CHERRY HILL, NEW JERSEY 08034 PHONE: (856)429-4000 FAX: (856)429-5002 MR PROJECT NO: 0499-0124	Office of Construction and Facilities Management U.S. Department of Veterans Affairs	Drawing Title FOODSERVICE EQUIPMENT DRAWING PLAN - AREAS A & B	Phase BID DOCUMENTS	Project Title CONSTRUCT NEW COMMUNITY LIVING CENTER (CLC)	Project Number 595-601
	PreBid RFIs Revisions:	Date: 2024-07-26	Location LEBANON, PENNSYLVANIA	Building Number CLC-1	Drawing Number QC101			