

# REPAIR BUILDING 1 SPRINKLER MAIN

DEPARTMENT OF VETERANS AFFAIRS PROJECT NO. 503-25-103  
 JAMES E. VAN ZANDT VA MEDICAL CENTER  
 BUILDING 1  
 2907 PLEASANT VALLEY BOULEVARD.  
 ALTOONA, PA 16602

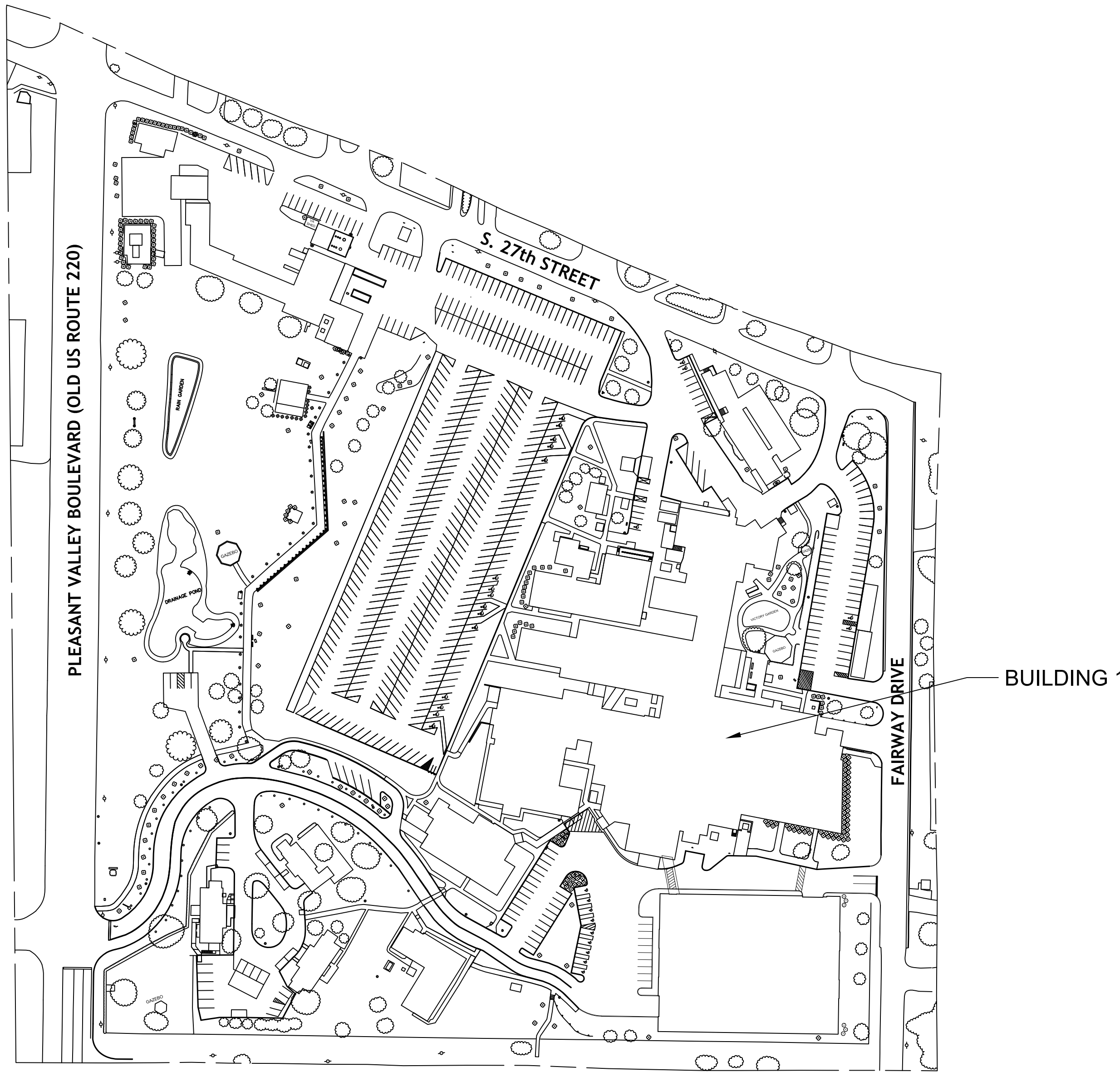

BUILDING KEY PLAN  
 SCALE: NTS  
 PLAN NORTH  
 ACTUAL NORTH

DRAWING INDEX

- GI001- COVER SHEET
- M100- OVERVIEW
- FP100- PIPING LAYOUT

6/14/2024 12:39:03 PM

File Path

		CONSULTANT	ARCHITECT/ENGINEER OF RECORD	STAMP	Office of Construction and Facilities Management  <b>VA</b> U.S. Department of Veterans Affairs	Drawing Title <b>Overview</b>  Approved: Project Director	Phase <b>Construction Documents</b>	Project Title Repair Bldg. 1 Sprinkler Main	Project Number 503-25-103 Building Number Building 1
Revisions:	Date:							Location James E Van Zandt VAMC	Drawing Number  <b>GI001</b>
								Issue Date 9/26/2024	Checked MD
								Drawn AH	

A  
B  
C  
D  
E  
F

A  
B  
C  
D  
E  
F

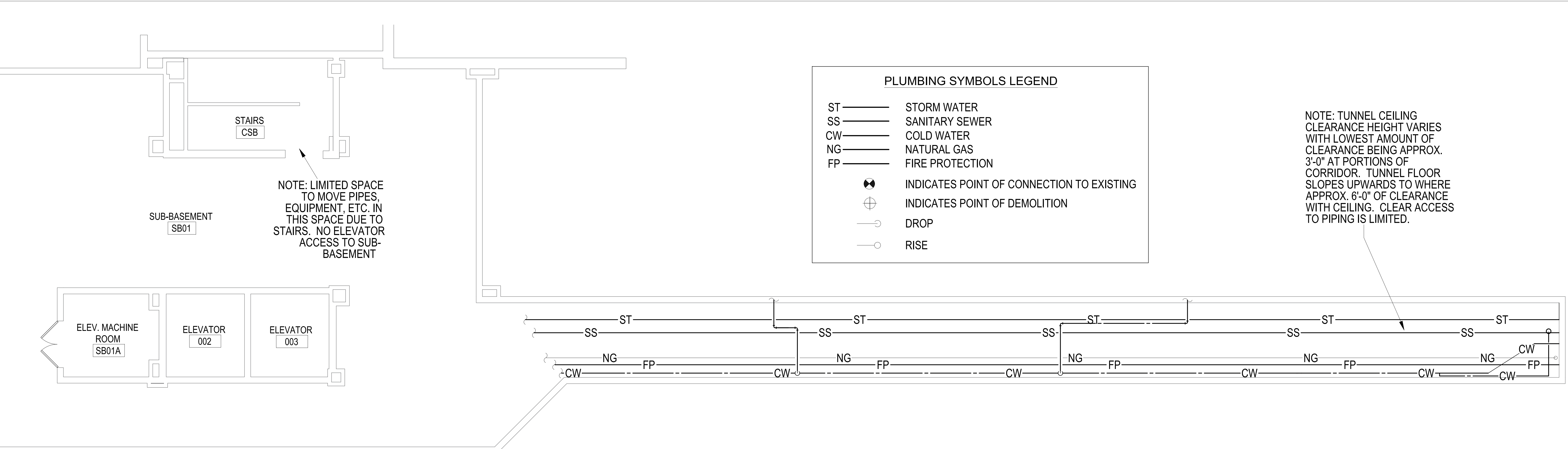

**PLUMBING SYMBOLS LEGEND**

- ST — STORM WATER
- SS — SANITARY SEWER
- CW — COLD WATER
- NG — NATURAL GAS
- FP — FIRE PROTECTION
- ⊗ — INDICATES POINT OF CONNECTION TO EXISTING
- ⊕ — INDICATES POINT OF DEMOLITION
- ↘ — DROP
- ↗ — RISE

NOTE: TUNNEL CEILING CLEARANCE HEIGHT VARIES WITH LOWEST AMOUNT OF CLEARANCE BEING APPROX. 3'-0" AT PORTIONS OF CORRIDOR. TUNNEL FLOOR SLOPES UPWARDS TO WHERE APPROX. 6'-0" OF CLEARANCE WITH CEILING. CLEAR ACCESS TO PIPING IS LIMITED.

NOTE: LIMITED SPACE TO MOVE PIPES, EQUIPMENT, ETC. IN THIS SPACE DUE TO STAIRS. NO ELEVATOR ACCESS TO SUB-BASEMENT

**1 SUB BASEMENT**  
1/4" = 1'-0"

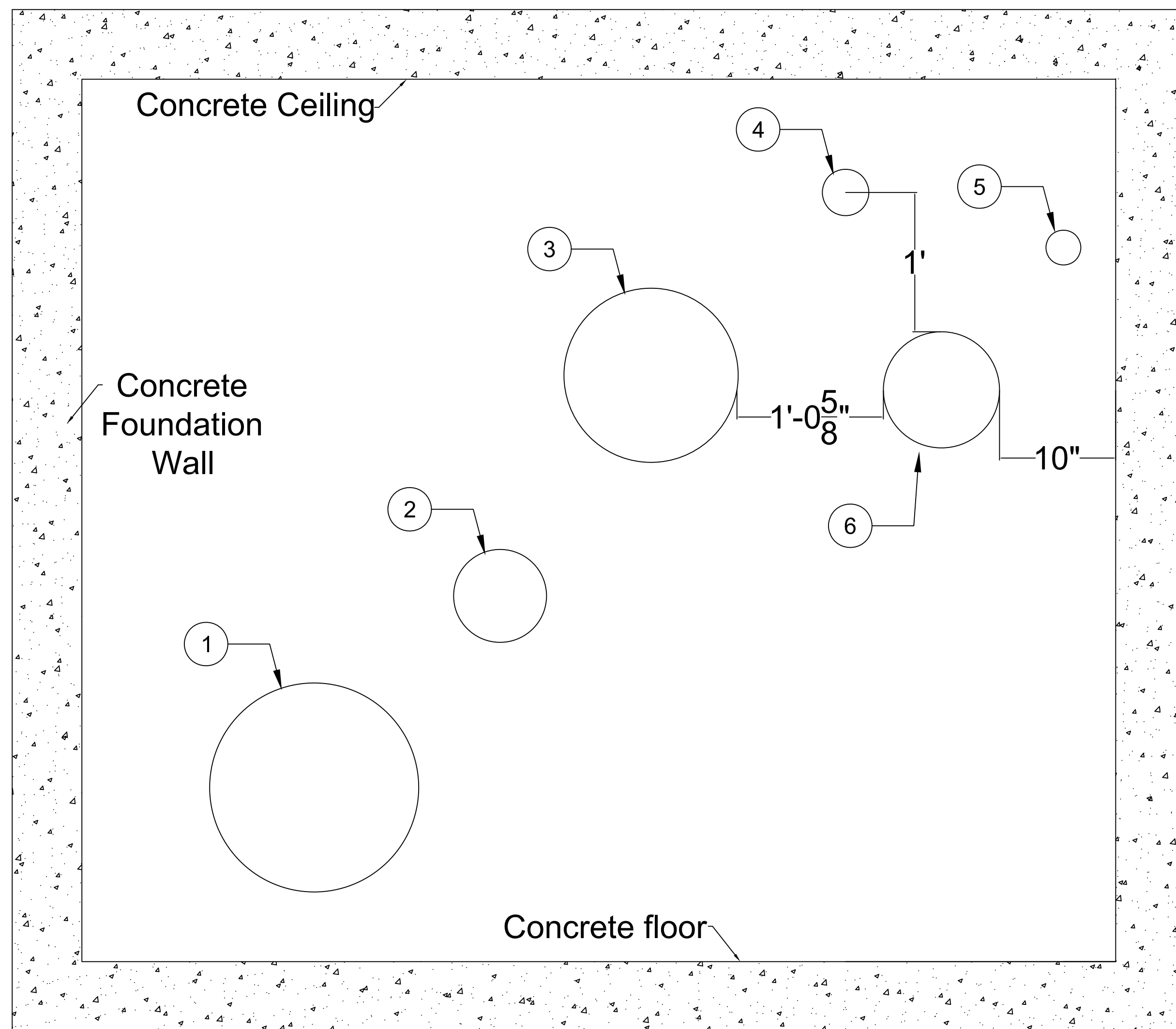

**2 PIPING CROSS SECTION**  
1/12" = 1'-0"

**SHEET KEYNOTES:**

1. 18" DIAMETER CAST IRON STORM WATER PIPE.
2. 10" DIAMETER CAST IRON SANITARY SEWER PIPE
3. INSULATED 6" DIAMETER DOMESTIC WATER LINE – 15" OVERALL DIAMETER
4. 4" NATURAL GAS PIPE
5. INSULATED 1 1/2" DOMESTIC WATER LINE – 3' OVERALL DIAMETER
6. 10" DIAMETER STEEL FIRE PROTECTION WATER LINE –REDUCES TO 6"

6/14/2024 12:36:53 PM

File Path

	<b>CONSULTANT</b>	<b>ARCHITECT/ENGINEER OF RECORD</b>	<b>STAMP</b>	<b>Office of Construction and Facilities Management</b>	<b>Drawing Title</b> Overview	<b>Phase</b> Construction Documents	<b>Project Title</b> Repair Bldg. 1 Sprinkler Main	<b>Project Number</b> 503-25-103
<b>Revisions:</b>				<b>VA</b> U.S. Department of Veterans Affairs	Approved: Project Director		<b>Location</b> James E Van Zandt VAMC	<b>Building Number</b> Building 1
<b>Date:</b>							<b>Issue Date</b> 9/26/2024	<b>Checked</b> MD
							<b>Drawn</b> AH	<b>Drawing Number</b> M100

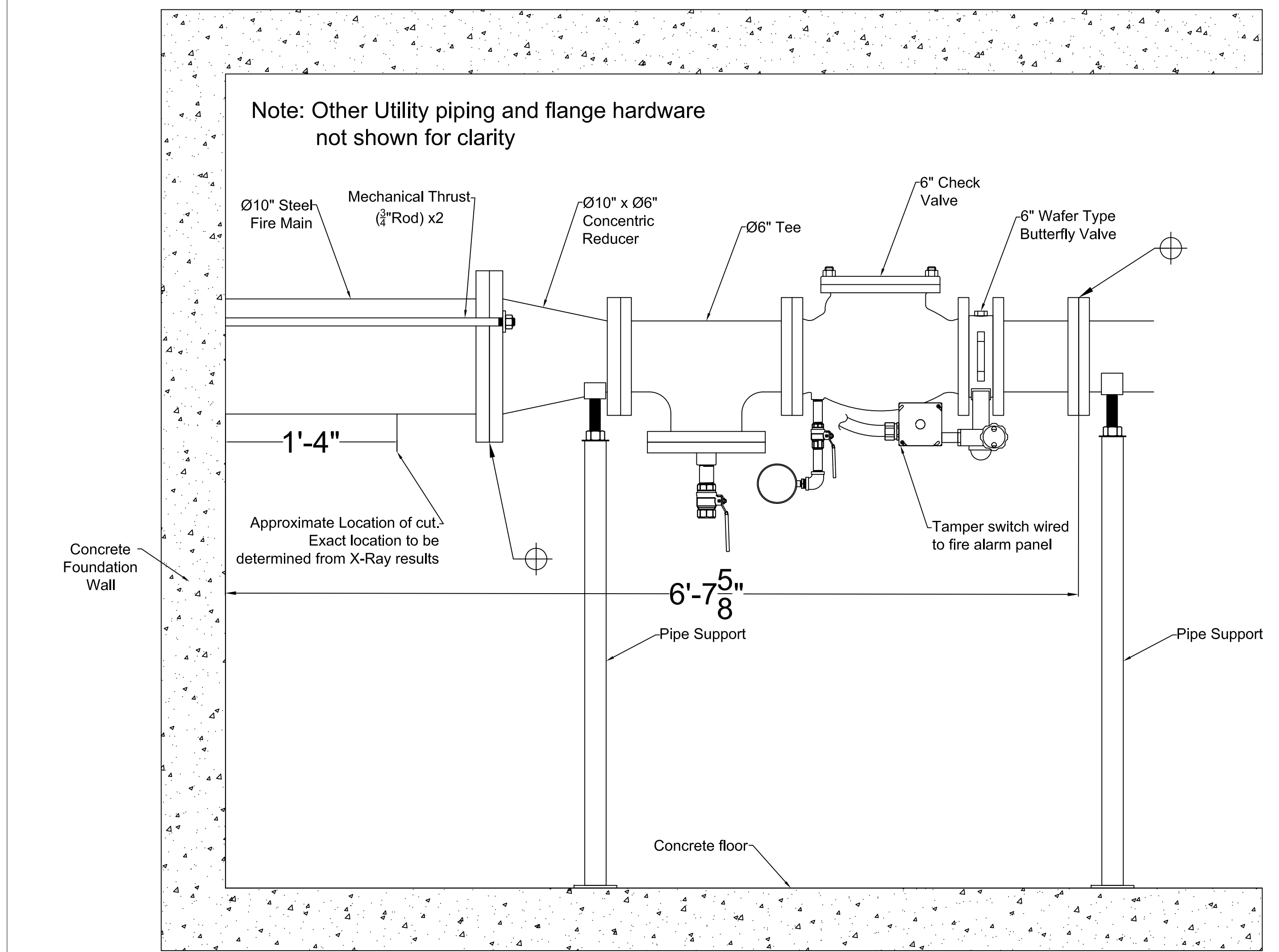

1 EXISTING SPRINKLER MAIN PIPING CONFIGURATION  
1 1/2" = 1'-0"

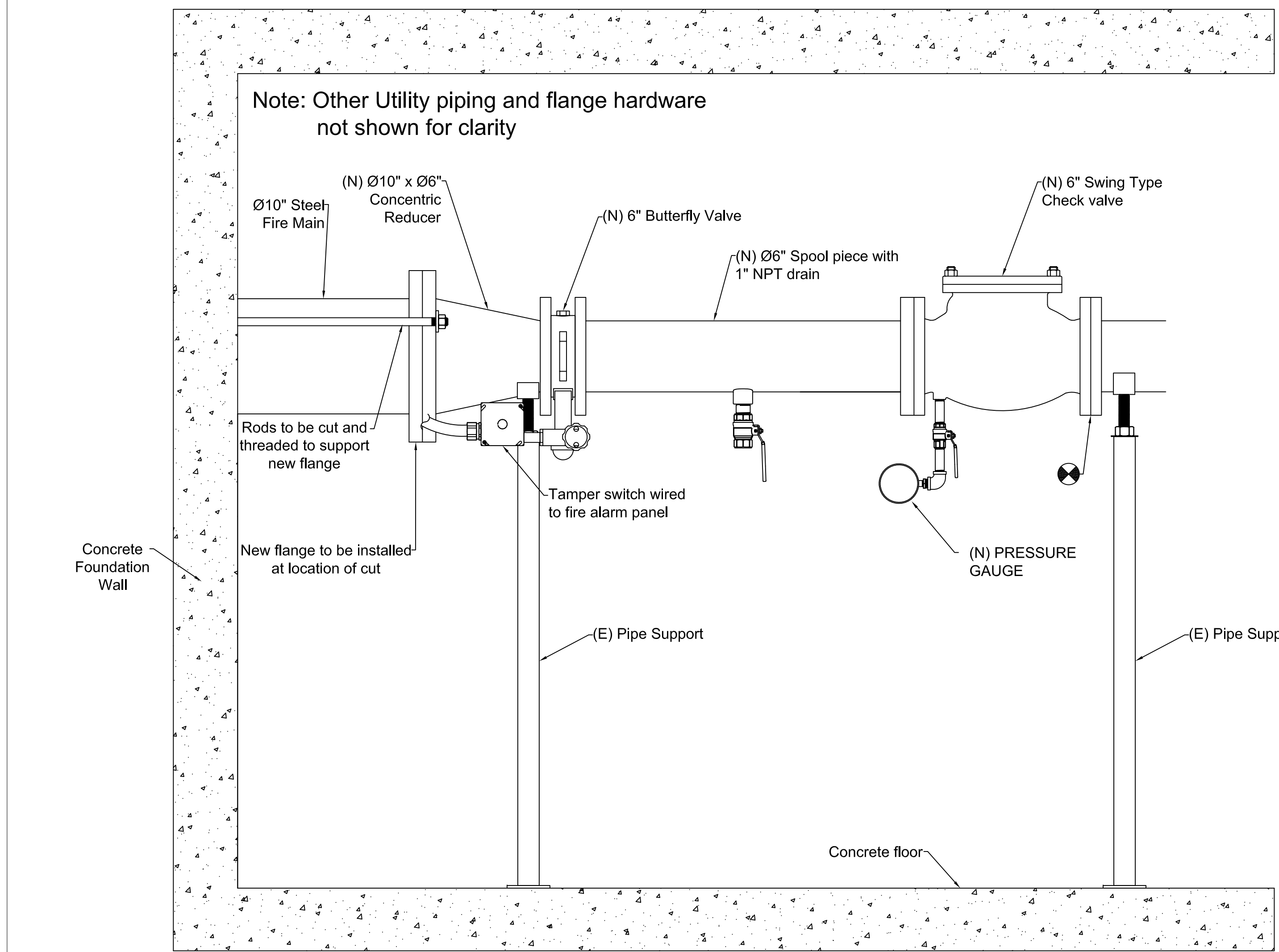

2 NEW SPRINKLER MAIN PIPING CONFIGURATION  
1 1/2" = 1'-0"

**LEGEND**

- ⊕ INDICATES POINT OF DEMOLITION
- ⊗ INDICATES POINT OF CONNECTION TO EXISTING
- (N) NEW - CONTRACTOR TO PROVIDE
- (E) EXISTING

### GENERAL NOTES:

1. CONTRACTOR MAY HAVE TO PERFORM OFF HOURS(NIGHTS AND/OR WEEKENDS) WORK TO COMPLETE REPAIRS.
2. CONTRACTOR WILL BE RESPONSIBLE TO PERFORM WORK TO MINIMIZE THE LOSS OF FIRE PROTECTION. WORK TO BE CONTINUOUS UNTIL FIRE PROTECTION RESTORED.
3. CONTRACTOR RESPONSIBLE FOR X-RAY SCAN OF EXISTING PIPE TO DETERMINE BEST LOCATION FOR CUTTING AND INSTALLING NEW FLANGE.
4. ALL WORK TO COMPLY WITH THE VA FIRE PROTECTION DESIGN MANUAL, NFPA 101 LIFE SAFETY CODE, AND ALL OTHER APPLICABLE CODES ADOPTED BY THE VA. ALL EQUIPMENT AND FIXTURES SHALL BE INSTALLED PER THE MANUFACTURER'S RECOMMENDATIONS. ALL SPRINKLER PIPING SHALL CONFORM TO NFPA 13 STANDARD FOR THE INSTALLATION OF AUTOMATIC SPRINKLER SYSTEMS.
5. THE CONTRACTOR SHALL COORDINATE PIPE ROUTINGS WITH STRUCTURE, DUCTWORK, PIPING, LIGHTS, ETC. PIPING SHALL NOT BE INSTALLED ABOVE ELECTRICAL PANELS.
6. WATER SUPPLY FOR ALL CONTROL VALVES SHALL BE ELECTRICALLY SUPERVISED. WATER FLOW AND SUPERVISORY CIRCUITS SHALL BE IN ACCORDANCE WITH NFPA 13 STANDARD FOR THE INSTALLATION OF AUTOMATIC SPRINKLER SYSTEMS AND NFPA 72 NATIONAL FIRE ALARM CODE.
7. ALL PENETRATIONS THROUGH FIRE RATED CONSTRUCTION SHALL BE FIRESTOPPED. REFER TO SPECIFICATIONS.
8. ALL PIPING TO BE PAINTED RED PER SPECIFICATION.
9. DRAWINGS ARE DIAGRAMMATIC. CONTRACTOR TO FIELD VERIFY PIPE ROUTING AND COORDINATE INTERFERENCE BETWEEN TRADES PRIOR TO INSTALLATION.
10. PROVIDE ALL MATERIALS, EQUIPMENT AND PERFORM ALL LABOR REQUIRED TO INSTALL COMPLETE AND OPERABLE PLUMBING SYSTEMS AS INDICATED ON THE DRAWINGS, AS SPECIFIED AND AS REQUIRED BY CODE.
11. CONTRACT DOCUMENT DRAWINGS FOR PLUMBING WORK ARE DIAGRAMMATIC AND ARE INTENDED TO CONVEY SCOPE AND GENERAL ARRANGEMENT ONLY. CONTRACTOR SHALL BE RESPONSIBLE TO FIELD SURVEY ACTUAL SITE CONDITIONS AND ACCOMMODATE ACTUAL SITE CONDITIONS AS PART OF SCOPE OF WORK AT NO COST TO GOVERNMENT.
12. DRAWINGS MAY NOT INDICATE ALL DEMOLITION/REMOVALS. CONTRACTOR SHALL REFER TO DRAWINGS, SPECIFICATIONS AND VERIFY FIELD CONDITIONS TO DETERMINE FULL SCOPE AND PARTICULARS OF REMOVALS AS REQUIRED FOR AND COORDINATED WITH THE NEW WORK PRIOR TO BIDDING WORK. VERIFY AND CONFIRM WITH OWNER WHICH ITEMS ARE TO BE SAVED FOR OWNER'S USE OR REINSTALLATION BY CONTRACTOR.
13. INSTALL ALL PLUMBING EQUIPMENT AND APPURTENANCES IN ACCORDANCE WITH MANUFACTURER'S RECOMMENDATIONS, CONTRACT DOCUMENTS, APPLICABLE BUILDING, STATE AND LOCAL CODES, SEISMIC REQUIREMENTS, ENERGY CODES AND INSURANCE UNDERWRITER REQUIREMENTS.
14. COORDINATE CONSTRUCTION OF ALL PLUMBING WORK WITH ARCHITECTURAL, STRUCTURAL, CIVIL AND ELECTRICAL WORK, ETC. SHOWN ON OTHER CONTRACT DOCUMENT DRAWINGS.
15. LOCATE ALL TEMPERATURE, PRESSURE AND FLOW MEASURING DEVICES IN ACCESSIBLE LOCATIONS WITH STRAIGHT SECTION OF PIPE UPSTREAM AND DOWNSTREAM, AS RECOMMENDED BY THE MANUFACTURER FOR ACCURACY.
16. WHERE TWO OR MORE ITEMS OF THE SAME TYPE OF EQUIPMENT ARE REQUIRED, THE PRODUCTS OF A SINGLE MANUFACTURER SHALL BE USED.
17. COORDINATE ALL FINAL EQUIPMENT CONNECTIONS WITH THE MANUFACTURERS' CERTIFIED DRAWINGS. COORDINATE AND PROVIDE AND PIPING TRANSITIONS REQUIRED FOR FINAL EQUIPMENT CONNECTIONS TO FURNISHED EQUIPMENT. FIELD VERIFY AND COORDINATE PIPING DIMENSIONS BEFORE FABRICATION.
18. THE LOCATIONS AND SIZES OF ALL ITEMS SHOWN ON THE DRAWINGS OR CALLED FOR IN THE SPECIFICATIONS THAT ARE NOT DEFINITELY FIXED BY DIMENSIONS ARE APPROXIMATE ONLY. THE EXACT LOCATIONS AND SIZES NECESSARY TO SECURE THE BEST CONDITIONS AND RESULTS SHALL BE DETERMINED BY THE PROJECT SITE CONDITIONS AND SHALL HAVE THE APPROVAL OF THE ENGINEER BEFORE BEING INSTALLED. DO NOT SCALE DRAWINGS.
19. PLAN DRAWINGS AND SECTIONS CUTS WHICH SPECIFICALLY IDENTIFY SERVICE ROUTE OFFSETS, ELEVATION CHANGES, OBSTRUCTIONS, ACCESS DOORS, BALANCING DEVICES, ETC. ARE SHOWN FOR CLARITY WHERE SPECIFIC KNOWN CONDITIONS EXIST. PLUMBING CONTRACTOR SHALL COORDINATE EQUIPMENT AND PIPING ROUTINGS WITH ALL OTHER TRADES. REQUIREMENTS NOT SPECIFICALLY IDENTIFIED SHALL NOT BE INTERPRETED AS EXCLUSION FROM CONTRACTOR'S SCOPE OF WORK. CONTRACTOR SHALL BE RESPONSIBLE FOR ACTUAL SITE CONDITIONS AND SHALL INCLUDE SUCH CONDITIONS IN SCOPE OF WORK AT NO ADDITIONAL COST TO THE OWNER.
20. ALL MISCELLANEOUS STEEL REQUIRED TO ENSURE PROPER INSTALLATION AND SUPPORT OF PLUMBING WORK AS SHOWN IN DETAILS FOR PIPING, AND EQUIPMENT (UNLESS OTHERWISE NOTED) SHALL BE FURNISHED AND INSTALLED BY THE PLUMBING CONTRACTOR AT NO ADDITIONAL COST TO THE GOVERNMENT.
21. ALL EQUIPMENT, PIPING, ETC., SHALL BE SUPPORTED AS DETAILED, SPECIFIED AND AS REQUIRED TO PROVIDE A VIBRATION FREE INSTALLATION.
22. ALL OPENINGS IN FIRE RATED WALLS AND SMOKE PARTITIONS DUE TO PIPING, CONDUIT, ETC., SHALL BE FIRE STOPPED WITH APPROVED FIRESTOPPING MATERIALS.
23. LOCATE ALL EQUIPMENT SO THERE IS UNOBSTRUCTED ACCESS TO UNIT ACCESS PANELS, CONTROLS AND VALVING.
24. INSTALL PIPING SO THAT ALL VALVES, STRAINERS, UNIONS, TRAPS, FLANGES AND OTHER APPURTENANCES REQUIRING ACCESS ARE ACCESSIBLE.
25. ALL ISOLATION VALVES SHALL BE IN LOCATION AND ELEVATION WHICH ALLOWS FOR EQUIPMENT AND BRANCH PIPING REMOVAL, WHILE MAINTAINING SERVICE UPSTREAM OF THE ISOLATION VALVE.
26. MEASURE, CUT AND INSTALL PIPE LENGTH ACCURATELY TO MINIMIZE MISALIGNMENT. INSTALL ALL PIPING WITHOUT FORCING OR SPRINGING.
27. ALL PIPING, AND EQUIPMENT SUPPORTED FROM STRUCTURAL STEEL SHALL BE COORDINATED WITH GENERAL CONTRACTOR. ALL ATTACHMENTS TO STEEL MEMBERS, BAR JOISTS, TRUSSES, OR JOIST GIRDERS SHALL BE APPROVED BY STRUCTURAL ENGINEER. WELDING TO STRUCTURAL MEMBERS SHALL NOT BE PERMITTED.
28. ALL PIPING AND DUCTWORK SHALL CLEAR DOORS, WINDOWS, EQUIPMENT CLEARANCES, MAINTENANCE REQUIREMENTS, CODE SETBACKS, ETC. TO ASSURE PROPER OPERATION, INSPECTION AND MAINTENANCE.
29. ALL VALVES SHALL BE ADJUSTED FOR SMOOTH AND EASY OPERATION.
30. ALL EQUIPMENT SUBMITTALS AND SHOP DRAWINGS REQUIRED BY THE SPECIFICATIONS SHALL BE APPROVED BY THE ENGINEER PRIOR TO PURCHASE, FABRICATION AND INSTALLATION.
31. ALL DEVICES AND SURFACES WITH ELEVATED TEMPERATURES WHICH CAN BE ACCESSED OR COME IN CONTACT WITH OWNER PERSONNEL SHALL BE PROTECTED, INSULATED, OR CONTROLLED TO REMAIN BELOW 120° F.

6/14/2008 12:38:03 PM

File Path

Revisions:	Date:

CONSULTANT	ARCHITECT/ENGINEER OF RECORD	STAMP

<b>Office of Construction and Facilities Management</b> U.S. Department of Veterans Affairs	Drawing Title <b>Piping Configuration</b>	Phase <b>Construction Documents</b>	Project Title <b>Repair Bldg 1 Sprinkler Main</b>	Project Number <b>503-25-103</b>
	Approved: Project Director		Location <b>James E Van Zandt VAMC</b>	Building Number <b>Building 1</b>
	Issue Date <b>9/26/24</b>	Checked <b>MD</b>	Drawn <b>AH</b>	Drawing Number <b>FP100</b>